

Owner's Manual

EDGE RT

REMOTE CONTROLLED
DOG TRAINING COLLARS



Dogtra Company

22912 Lockness Avenue
Torrance, CA 90501 U.S.A.

Tel. 310.534.0101

Fax. 310.534.9111

Toll Free. 1.888.811.9111

Website. www.dogtra.com

Copyright © 2020 Dogtra Company All rights reserved.

Ver.4



EDGE RT

Remote Controlled Dog Training Collars

Owner's Manual

Please read this manual thoroughly
before operating the EDGE RT

IMPORTANT SAFETY AND PRODUCT INFORMATION

WARNING

Please read all safety and product information below before using your Dogtra product. Failure to follow these safety instructions could result in injury to you, your dog and others, or it could result in damage to your Dogtra product or other property.

PRODUCT SAFETY

Training Methods

Dogtra products may be used with a variety of training methods. However, each dog may have a different reaction to training methods and to Dogtra products. Closely observe your dog when determining the right training method to use with your Dogtra product.

Aggressive Dogs

Do not use Dogtra products with aggressive dogs as such dogs may react adversely and cause injury to people or other dogs. Seek the assistance of a dog-training specialist or veterinarian when dealing with aggressive dogs.

Children

Dogtra products are not toys. Adult supervision and close attention are necessary when Dogtra products are used by or near children.

PRODUCT DAMAGE

Electrical Product

Your Dogtra product contains electrical components and batteries. Do not use or keep your product near heat or flammable sources. Such use or storage may damage your

product and/or cause fire, explosion, injury, or property damage.

Medical Device Interference

Dogtra products contain electrical and magnetic components that emit low level electromagnetic waves and radio frequencies. These electromagnetic waves or radio frequencies may interfere with pacemakers, defibrillators, or other medical devices. Consult your physician or medical device maker before using your medical device with a Dogtra product. If you think that your Dogtra product is interfering with your pacemaker, defibrillator, or other medical device, stop using the Dogtra product.

Inadvertent Activation

The digital microprocessor offers thousands of unique codes to eliminate frequency match-up with other Dogtra e-collars. The Constant button will automatically shut down after being held down for 12 seconds or more as a safety feature.

UNAUTHORIZED USE

Your Dogtra product should be used only in a humane manner to train and educate your dog. Dogtra products are not intended for use in any other manner nor are they intended for use with other animals or with humans.

BATTERY

Your Dogtra product contains batteries. Take care when removing and installing batteries as your fingers may get caught. Dispose of batteries as provided by your local regulations. Do not disassemble, crush, heat, or otherwise alter the battery as it may cause fire, injury or property damage.

CONTENTS

AT A GLANCE	5
MAIN FEATURES	6
OVERVIEW	7
UNDERSTANDING YOUR TRAINING SYSTEM	
1. TURNING THE EDGE RT ON/OFF	9
2. THE STIMULATION/COMBINATION BUTTONS	10
3. HOW TO USE THE DOG SELECTOR DIAL	12
4. COLLAR FITTING	12
5. HOW TO FIND THE RIGHT STIMULATION	13
6. TO MAXIMIZE THE DISTANCE	14
7. LED INDICATOR	15
8. CHARGING THE BATTERY	16
9. HOW TO CHANGE THE LENGTH OF THE CONTACT POINTS	17
10. CODE SETTING	19
11. HOW TO ATTACH THE BELT CLIP ON THE EDGE RT	21
12. HOW TO USE THE TEST LIGHT	22
GENERAL TRAINING TIPS	23
MAINTENANCE	25
TROUBLESHOOTING GUIDE	26
WARRANTY AND REPAIR INFORMATION	29

AT A GLANCE

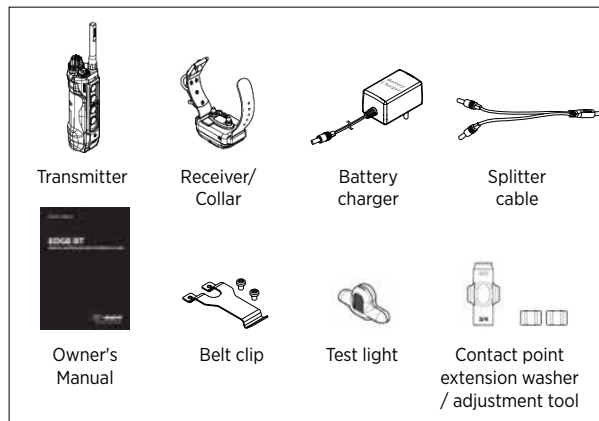

Optional Accessories

Auto Charger

Dogtra's field auto chargers are designed for use with a 10-volt car outlet.

European Charger

Dogtra's European chargers are designed for use with a 230V AC electrical outlet.

To purchase accessories, please visit Dogtra's online store at shop.dogtra.com or call customer service at 1-888-811-9111.

MAIN FEATURES

- Intensity selection dial stimulation level (1-8)
- 1-Mile range
- Nick/Constant/non-stimulating Pager vibration modes
- Stimulation/Combination buttons
- User expandable to a three-dog system
- Fully waterproof
- Enhanced Contact Points
- Belt clip
- 2-hour rapid charge batteries
- Low/High Stimulation
- For dogs as small as 35 lbs.

OVERVIEW

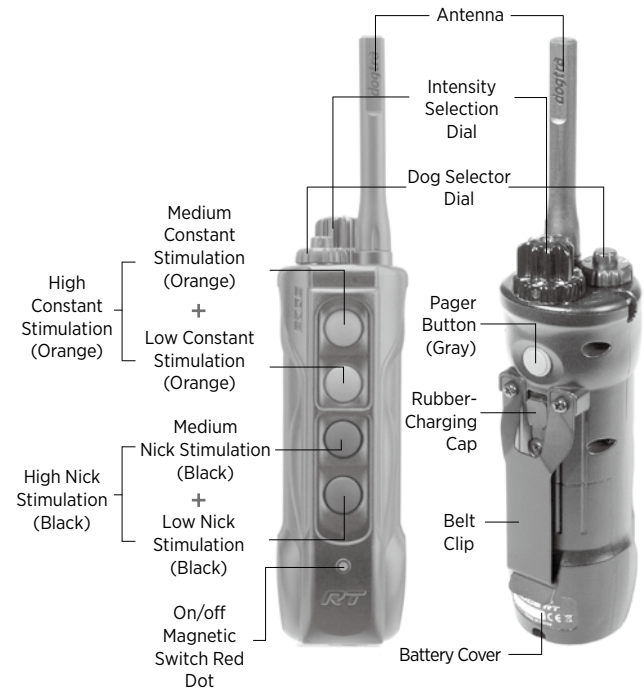

**EDGE RT
Transmitter**

UNDERSTANDING YOUR SYSTEM

1. How to Turn the EDGE RT On/Off

To activate the receiver/collar, place the red dot on the front of the transmitter to the red dot on the receiver/collar. Hold the two red dots together for a moment until the LED light on the receiver/collar comes on. While the receiver/collar is on, the LED light will blink every 4 seconds.

To deactivate the receiver/collar, repeat the same procedure holding the two red dots together momentarily. The LED light will turn red for a brief moment indicating that the receiver/collar is now shut off.

The handheld transmitter will turn on when a button is pressed and turn off automatically when not in use.

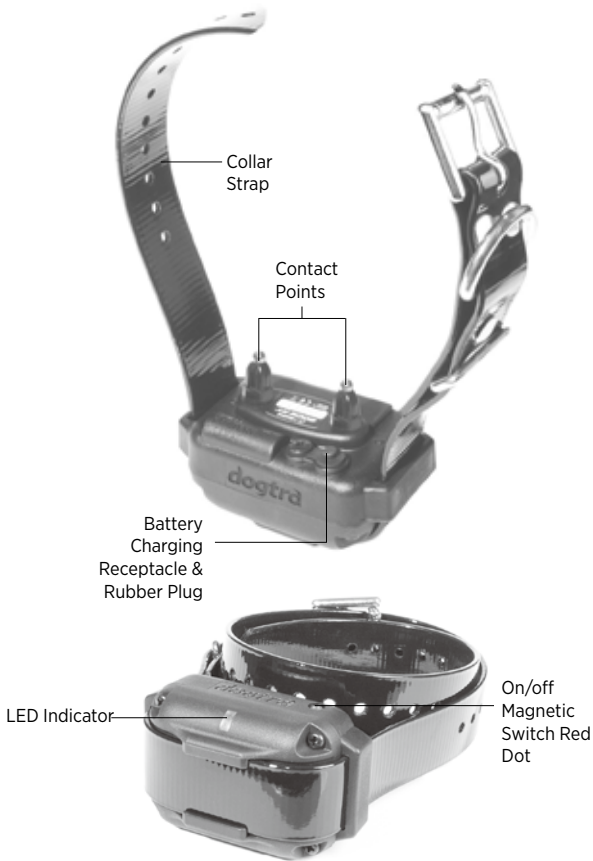
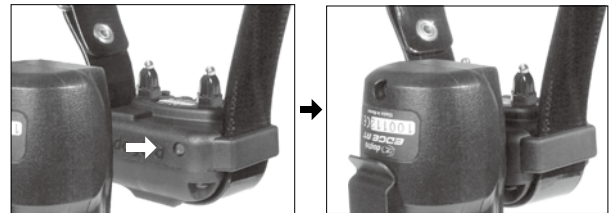

EDGE RT
Receiver/Collar

2. The Stimulation/Combination Buttons

The handheld transmitter uses 4 buttons to send stimulation. The LED indicator will blink on both the handheld transmitter and the receiver/collar when the stimulation buttons are pressed.

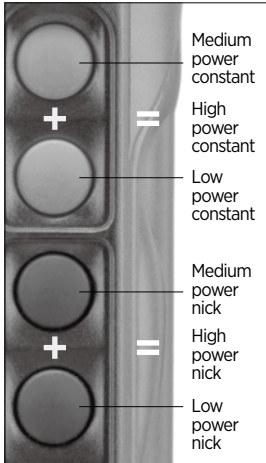

1) Constant Stimulation

The two orange buttons on the front of the transmitter control 3 levels of Constant stimulation.

- Low Power Constant:

Press the lower orange button for Low Power Constant stimulation.

- Medium Power Constant:

Press the top orange button for Medium Power Constant stimulation.

- High Power Constant:

Press both orange buttons together for High Power Constant stimulation.

2) Nick Stimulation

The two black buttons on the front of the transmitter control 3 levels of Nick/momentary stimulation.

- **Low Power Nick:** Press the lower black button for Low Power Nick/momentary stimulation.

- **Medium Power Nick:** Press the top black button for Medium Power Nick/momentary stimulation.

- **High Power Nick:** Press both black buttons together for High Power Nick/momentary stimulation.



12 sec

* Holding down the constant stimulation buttons will activate for a maximum of 12 seconds. After 12 seconds of constant stimulation, the stimulation will reset. The stimulation reactivates once the constant button is released and pressed again.

3) Pager Vibration

The Pager vibration button is located on the back of the handheld transmitter. The LED indicator will blink on both the handheld transmitter and the receiver/collar when the Pager button is pressed.

* Holding down the Pager button will activate for a maximum of 12 seconds, until it is released and pressed again.



3. How to Use the Dog Selector Dial

The EDGE RT is expandable to use as a 3-dog system.



- **DOG 1:** Set the dial to 1 to control dog 1
- **DOG 2:** Set the dial to 2 to control dog 2
- **DOG 3:** Set the dial to 3 to control dog 3

4. Collar Fitting

The receiver/collar should be fitted so that the surgical stainless steel contact points press firmly against the dog's skin. When properly fitted, you should be able to fit a finger or two snugly in between the contact points and your dog's skin. When properly fitted, the receiver/collar should not move on the dog. The best location for the receiver/collar box is either side of the dog's windpipe. A loose fit can allow the receiver/collar to move around on the dog's neck. When this happens, the contact points may rub the skin and cause irritation. If the receiver/collar is too tight, the dogs may have difficulty breathing.

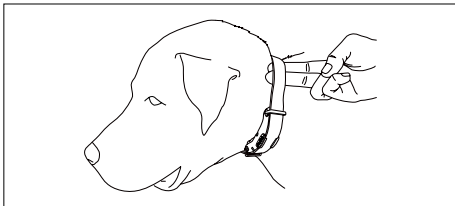

5. How to Find the Right Stimulation

The stimulation intensity can be adjusted using the stimulation selector dial on top of the handheld transmitter. There are 8 levels of stimulation intensity, with level 1 being the lowest level and level 8 being the highest.

The level of stimulation best suited for your dog depends on your dog's temperament and threshold for stimulation. Always start at the lowest level and work your way up. The appropriate level can be found when the dog responds to the stimulation with a mild reaction, such as a tensing of the neck muscles.

The stimulation level may vary depending on the training situation. When highly distracted, dogs will require a higher level of stimulation.

6. To Maximize the Distance

The EDGE RT has a 1-mile range. The range may vary depending on the way the transmitter is held. Hold the transmitter away from your body to receive the greatest range. For maximum signal strength, keep the EDGE RT properly charged.

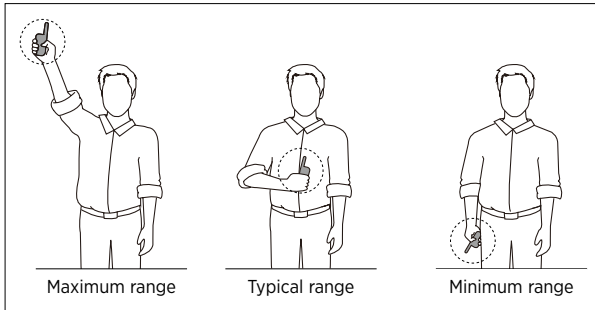

*Avoid touching the antenna or the range may decrease substantially.

7. The LED Indicator

The LED indicator flashes every 4 seconds when the receiver is on and ready for use. The LED indicator will blink on both the transmitter and the receiver when the transmitter buttons are pressed.

The LED indicator color indicates the battery life level. **Green** = Fully charged, **Amber** = Medium, **Red** = Needs charging

If the unit is used while the LED indicator is red, it will shut down automatically.



8. Charging the Battery

1. Lift the rubber-charging cap and plug in the charger.
 2. Plug the adapter's power plug in to a standard AC wall outlet. The LED indicator on the transmitter and receiver/collar will turn red.
 3. When the unit is fully charged, the LED indicator will turn green on both the transmitter and receiver/collar. Unplug the adapter's power plug from the AC wall outlet and disconnect the charger from the unit.
 4. Place the rubber-charging cap back over the charging port.
- * The transmitter and receiver/collar rubber-charging cap ensures dirt and debris does not build up in the charging port area. The unit is waterproof even if the rubber-charging cap is not fully closed.

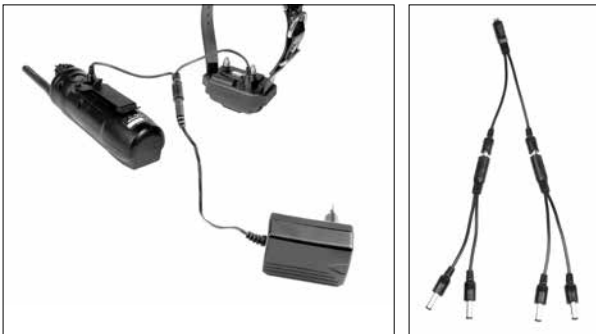

Using the EDGE RT as a 2 or 3 Dog System

To charge multiple receivers/collars and a transmitter, combine additional splitter cables as shown above. Connect 2 splitter cables together to charge all parts of a 2-dog system, or connect 3 splitter cables together to charge all parts of a 3-dog system, at the same time.

* Warning

1. Fully charge the unit before the first use.
2. Do not charge the unit near any flammable substances.
3. Fully charge the unit before storing for one month or longer.
4. Always use Dogtra approved charging adapters.

9. How to Change the Length of the Contact Points

The Dogtra EDGE RT comes equipped with standard 5/8" contact points that can be extended to 3/4" contact points, for use with dogs with longer coats. To increase the contact point length from 5/8" to 3/4", follow the steps below.

1. Using the included adjustment tool with the side marked 5/8", unscrew the contact points counter-clockwise.
2. Place the contact point extension over the exposed threads, flat side down.
3. Place the contact points over the extensions and tighten the contact points and extensions clockwise using the adjustment tool with the side marked 3/4".

* **Caution:** Tighten until firmly in place. Be careful not to over tighten.

To shorten the contact points back to the standard 5/8", start with the adjustment tool with the side marked 3/4", remove the contact point extensions, and tighten the contact points with the adjustment tool with the side marked 5/8".

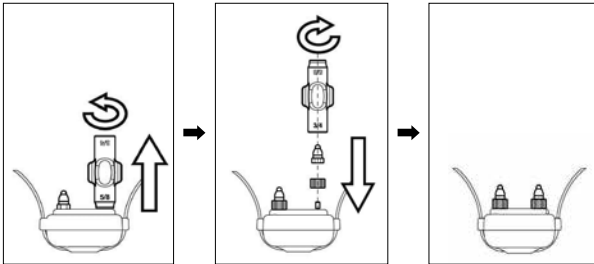

10. Code Setting

To set the coding for the Dogtra EDGE RT transmitter to an existing receiver/collar, or an Additional receiver/collar, follow the steps below.

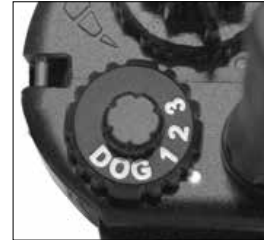

1. Set the stimulation dial to level 1, and select between dog 1, 2, and 3 with the dog selector dial on the handheld transmitter.



2. With the receiver/collar turned off, hold the red dot on the front of the transmitter to the red dot on the receiver/collar for about 5 seconds.



3. **IMPORTANT!** Place the receiver/collar aside when the LED indicator rapidly blinks green on the receiver/collar. Take caution not to touch the contact points on the receiver/collar during step 3 or you may receive an electric stimulation.



4. Within 5 seconds of separating the transmitter and receiver/collar, hold down the top orange/constant button on the front of the transmitter and the Pager button on the back of the transmitter at the same time. The code setting is complete when the LED indicator resumes blinking every 4 seconds on the receiver/collar.



Do not touch the contact points of the receiver/collar while code setting the EDGE RT. If you do so, you may receive an electric stimulation. Also, do not attempt to code set the device while the receiver/collar is in contact with dogs, other animals, or people.

11. How to Attach the Belt Clip on the EDGE RT

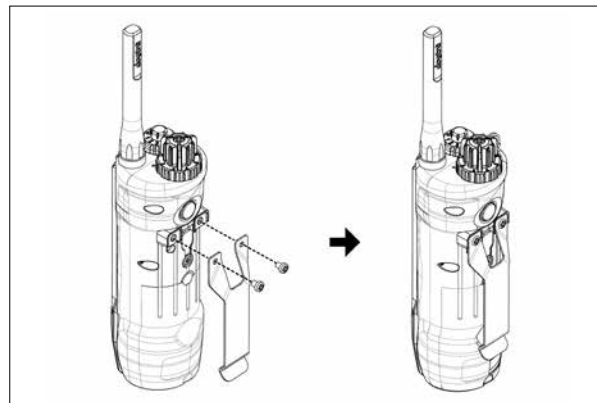

To attach the included belt clip to the transmitter, follow the instructions below.

1. Align the belt clip to the grooves on the back of the transmitter.
2. With a firm grip, screw on the belt clip using the provided Philips head screws.

Caution!

Tighten until firmly in place. Be careful not to over tighten.

12. How to Use the Test Light

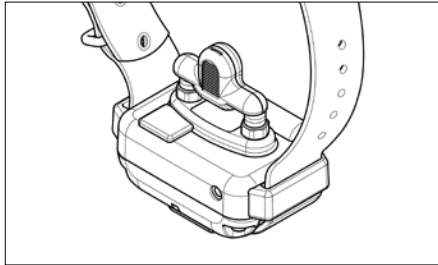

1. Turn on the receiver/collar and place the test light over the contact points as shown in the diagram.
2. The test light will illuminate momentarily when the Nick stimulation button is pressed on the transmitter. The light will stay lit as long as the Constant button is pressed on the transmitter, up to 12 seconds.
3. When the stimulation is increased, the test light will emit a brighter light.

GENERAL TRAINING TIPS

Getting started with your EDGE RT

Your dog must know some very basic obedience commands before beginning training with the EDGE RT. A dog learns by first being shown a command, followed by lots of repetition over an extended period. As the dog becomes proficient at these commands, the trainer can introduce distractions and different locations to strengthen them. Throw in the correct amount of positive and negative reinforcement and you should end up with a well-mannered dog.

Obedience training on the leash

Your dog must fully understand the obedience commands (sit, stay, here, heel and kennel) before using the e-collar for reinforcement of these commands. A leash attached to a standard collar is used to "teach" the dog the basic obedience commands (here, heel, sit, and stay). A tug on the leash/collar is used to reinforce the command. When the dog complies with the command, use positive reinforcement/praise. Once the dog understands these commands, the e-collar can be used to reinforce them.

Beginning e-collar training

When you feel your dog understands the obedience commands on the leash we can now start with the electric collar training. With the dog on the leash wearing the electric collar continue with your obedience drills. Light stimulation (nick or constant) is going to be applied as a command is given, the stimulation is removed as the dog complies. Through repetition, a dog learns to turn off the light stimulation by performing the command. E-collar training is another form of negative reinforcement, similar

to the leash and standard collar training. When the dog complies with the command, we use praise/positive reinforcement. The final step is the avoidance phase in which the dog learns that he can avoid the stimulation altogether by performing your commands. When these training procedures are complete, the electric collar is used as a reminder when the dog does not comply with your commands at home or in the field. Keep your initial training sessions short and positive. Dogs have a short attention span, especially young dogs.

How much stimulation to use

Always start with low levels of stimulation and work your way up depending on the disposition of your dog and any given situation. By using only enough stimulation to get your point across, you will have a more controllable environment and a dog that is under less stress. Animals (and humans) perform better in a less stressful environment.

For more training information, please visit our website at www.dogtra.com.

MAINTENANCE

Basic maintenance

Be sure the rubber-charging cap is securely in place when the collar is in use. After each training session, carefully inspect the unit for any missing parts or damage to the casing. Damaged or broken casing may affect the waterproof guarantee on the unit. After confirming that there is no damage to the casing, rinse the receiver/collar and clean out any dirt or debris.

Storage maintenance

The EDGE RT should be fully charged before storing for extended periods. While in storage, the unit should be given a full charge once a month, and before the first use. Store the units in room temperature. Do not keep the units exposed to extreme climates.

Troubleshooting

If the unit is malfunctioning, please refer to the “Troubleshooting Guide” before sending it to Dogtra for service. If you have any questions or concerns, you may email them to info@dogtra.com, or call customer service at 1-888-811-9111.

TROUBLESHOOTING GUIDE

1. My dog is not reacting to the collar.

- Make sure the receiver/collar is turned on. To turn on/off the receiver/collar, hold the red dot on the front of the transmitter to the red dot on the receiver/collar.
- Be sure the strap is on the dog tight enough so that both contact points are touching the dog's skin.
- The contact points may be too short for your dog's thick or long coat. To place an order for longer contact points, please contact Dogtra or a Dogtra dealer. If you are already using longer contact points, you may need to trim the hair on the dog's neck, so that both contact points are touching the dog's skin.
- The intensity level may be too low for your dog. Increase the stimulation until the dog responds, usually by a neck movement, head shaking, or looking over the shoulders. The response may be very subtle.

2. The LED indicator light comes on, but I do not feel any stimulation.

- Your tolerance may be higher than your dog's. You may need to try the unit on your fingertips where sensitivity is higher and/or increase the stimulation level. Be sure both contact points are touching both of your fingertips.
- The battery may be low, check the LED indicator light on the transmitter and receiver/collar for battery life.
- Make sure the receiver/collar is coded to the transmitter. To code the receiver/collar to the transmitter see section 10. Code Setting.
- If you have a full charge, and you have done all of the above, your unit may need to be serviced. Please email

us at info@dogtra.com, or call customer service at 1-888-811-9111.

3. The transmitter has no range, or the stimulation is weaker when my dog is farther away.

- Check to see if your fingers are touching the antenna, as the range may decrease substantially.
- The range indicated on the unit's box is for flat terrain (line of sight). Heavy brush, trees, hills, buildings, and/or moisture will affect the range of your unit. For the best range, hold the transmitter vertically above your head, and/or try moving to higher ground.
- Any electrical conductors will affect the range, such as cars, chain-link dog runs, metal buildings, and radio towers. For the best results, operate away from these structures.

4. My units are not holding a charge.

- The charging pin may be damaged. A metal pin inside the charging port should stand straight up and firm in the center.
If the pin is wobbling, broken or missing, you will need to send the unit in to the repairs department.
- The charging port must be clean prior to charging, clean the dirt out with a cotton swab and some rubbing alcohol. If the dog was in salt-water, be sure to rinse the receiver and charging port with clean water.
- For Dogtra units over two years old from the purchase date, the batteries may need to be replaced. Dogtra strongly recommends sending the unit in for battery replacement and inspection. Damages incurred to the unit due to improper battery installations are not covered under the warranty.

5. My dog has skin irritation.

- This may be due to an improper fit or from wearing the unit too long. If your dog exhibits signs of skin irritation, consult with a veterinarian. Once the dog's skin returns to a normal condition, continue to use the collar and check your dog's neck each time you use the unit.

DOGTRA EXTENDED PRODUCT WARRANTY

EXTENDED LIMITED WARRANTY

For Certain Dogtra Products Purchased from Dogtra Authorized Dealers

1+1 Year Extended Warranty

Except as otherwise provided, Dogtra warrants to the original retail purchaser ("You") that your Dogtra product shall be free of defects in materials and workmanship for a period of one (1) year from the date of purchase ("Original Warranty"). As a special promotion, Dogtra further warrants that your Dogtra product shall be free of defects in materials and workmanship for an additional one (1) year from the date that your original warranty expires ("Extended Warranty"). The Original and Extended Warranties cover the cost of repair (parts and labor) or replacement (if repair is not feasible) of a defective Dogtra product during said warranty periods. For such repaired or replaced products, the remaining portion of the warranty periods, or ninety (90) days, whichever is longer, shall apply. Dogtra, at its sole discretion, shall determine whether to repair or replace a product covered by the Original Warranty or Extended Warranty.

Warranty Conditions

The Original and Extended Warranties are not transferrable and apply to your Dogtra product only if:

- (1) You are the original retail purchaser of the product,
- (2) You bought the product from a Dogtra Authorized Dealer, and
- (3) You present a receipt or other proof of purchase showing a valid purchase date, the name and address of the Dogtra Authorized Dealer, and the purchased product identified by model and/or serial number.

Warranty Exclusions

The Original and Extended Warranties do not cover damage, loss, or deterioration to your Dogtra product caused: by misuse, neglect, abuse, or other improper handling of the product; by failure to follow use or care instructions; by use of the product for other than its intended purpose; by accident or natural forces such as fire or flooding; or by normal wear and tear such as scratches to the product surface.

The Original and Extended Warranties also do not cover Dogtra products that: are purchased from non-authorized dealers; are purchased outside of the United States or Canada; have been damaged during shipment (even if Dogtra paid or arranged for shipping); have been modified or tampered with in any manner; are opened or repaired by anyone other than Dogtra; or have serial numbers that have been altered or defaced.

Sole Warranties

The Original and Extended Warranties are the only warranties offered by Dogtra for your Dogtra product during said warranty periods. Other than the Original and Extended Warranties, Dogtra makes no other representations or warranties whatsoever regarding its products, whether oral or in any product manual, on any packaging, on any website, or in any other written material. No dealer of Dogtra products, nor any employee or agent of Dogtra, is authorized to make any additions, changes, or extensions to the Original Warranty or Extended Warranty. Dogtra, at its sole discretion and at any time, reserves the right to modify the Original and/or Extended Warranties.

DISCLAIMER OF OTHER WARRANTIES

THE FOREGOING ORIGINAL AND EXTENDED WARRANTIES ARE PROVIDED IN LIEU OF ALL OTHER WARRANTIES, WHETHER EXPRESS OR IMPLIED. DOGTRA DISCLAIMS ANY IMPLIED WARRANTIES INCLUDING, BUT NOT LIMITED TO, THE IMPLIED WARRANTIES OF MERCHANTABILITY AND FITNESS FOR A PARTICULAR PURPOSE.

Limitation of Remedies

Dogtra's liability is limited to the cost of repair or replacement of the Dogtra product under the Original Warranty or Extended Warranty. Any claim or action to enforce the Original and/or Extended Warranties must be commenced within thirty (30) days of such warranty's expiration for your product. Dogtra will not be liable for any indirect, incidental, special, consequential, or similar damages based on breach of warranty, breach of contract, negligence, strict tort, or any other legal theory related to Dogtra and its products. Damages that Dogtra will not be responsible for include, but are not limited to: loss of income or profits; loss of revenue or savings; loss of use of the product or associated products; cost of any substitute products or services; inconvenience, downtime, or any other time; loss of goodwill; claims of third parties including customers; and damage to property.

Legal Rights May Vary By State or Jurisdiction

The Original and Extended Warranties give You specific legal rights, and You may also have other rights which vary by state or jurisdiction. Some states or jurisdictions do not allow certain limitations of implied warranties or of incidental or consequential damages or other remedies, so certain of the foregoing limitations may not apply to You.

If any portion of the Original Warranty or Extended Warranty is held by a court to be invalid or unenforceable, the remaining portions of such warranties shall remain in full force and effect and shall in no way be affected or invalidated, and the invalid or unenforceable portion shall be modified so as to most nearly achieve the intent of the Original Warranty or Extended Warranty.

Product Registration

Dogtra recommends that customers register their products as soon as possible after purchase. Product registration will facilitate any future warranty service. You may also receive useful information and updates about your existing and future Dogtra products. To register your product, visit www.dogtra.com/product-registration. If your product is not registered with Dogtra, You will be required to provide a receipt or other proof purchase (as provided above) to qualify for warranty service.

How to Obtain Warranty Service

Should your Dogtra product require warranty service, please contact Customer Service by phone or email for a warranty evaluation (see below for contact information). Upon approval of your warranty work, Dogtra will repair or replace (at Dogtra's election) your product without charge for labor or parts. You are responsible for shipping, including cost, of your product to Dogtra for warranty service. Dogtra will handle shipping, including cost, of the repaired or replaced product back to customers in the USA. Dogtra will not be responsible for shipping, including cost and/or applicable taxes or fees, for products sent outside the USA. Such costs, taxes, or fees will be borne by the customer.

Dogtra Customer Service

22912 Lockness Avenue, Torrance, CA 90501

(888) 811-9111

repair@dogtra.com

Mon - Fri, 8:00 AM to 4:30 PM (PST)

© 2019 Dogtra. All rights reserved.