

# **EDGE**

EXPANDABLE TO 4-DOG SYSTEM

## **Owner's Manual**

Please read this manual thoroughly  
before operating the EDGE training e-collar.

# IMPORTANT SAFETY AND PRODUCT INFORMATION

## **WARNING**

**Please read all safety and product information below before using your Dogtra product. Failure to follow these safety instructions could result in injury to you, your dog and others, or it could result in damage to your Dogtra product or other property.**

## **PRODUCT SAFETY**

### **Training Methods**

Dogtra products may be used with a variety of training methods. However, each dog may have a different reaction to training methods and to Dogtra products. Closely observe your dog when determining the right training method to use with your Dogtra product.

### **Aggressive Dogs**

Do not use Dogtra products with aggressive dogs as such dogs may react adversely and cause injury to people or other dogs. Seek the assistance of a dog-training specialist or veterinarian when dealing with aggressive dogs.

### **Children**

Dogtra products are not toys. Adult supervision and close attention are necessary when Dogtra products are used by or near children.

## **PRODUCT DAMAGE**

### **Electrical Product**

Your Dogtra product contains electrical components and batteries. Do not use or keep your product near heat or flammable sources. Such use or storage may damage your

product and/or cause fire, explosion, injury, or property damage.

### **Medical Device Interference**

Dogtra products contain electrical and magnetic components that emit low level electromagnetic waves and radio frequencies. These electromagnetic waves or radio frequencies may interfere with pacemakers, defibrillators, or other medical devices. Consult your physician or medical device maker before using your medical device with a Dogtra product. If you think that your Dogtra product is interfering with your pacemaker, defibrillator, or other medical device, stop using the Dogtra product.

### **Inadvertent Activation**

The digital microprocessor offers thousands of unique codes to eliminate frequency match-up with other Dogtra e-collars. The Constant button will automatically shut down after being held down for 12 seconds or more as a safety feature.

### **UNAUTHORIZED USE**

Your Dogtra product should be used only in a humane manner to train and educate your dog. Dogtra products are not intended for use in any other manner nor are they intended for use with other animals or with humans.

### **BATTERY**

Your Dogtra product contains batteries. Take care when removing and installing batteries as your fingers may get caught. Dispose of batteries as provided by your local regulations. Do not disassemble, crush, heat, or otherwise alter the battery as it may cause fire, injury or property damage.

# CONTENTS

AT A GLANCE .....	6
MAIN FEATURES .....	7
OVERVIEW .....	8
UNDERSTANDING YOUR TRAINING SYSTEM	
1. TURNING THE EDGE ON/OFF.....	10
2. TRANSMITTER BUTTON FUNCTION .....	11
3. RECEIVER FITTING .....	13
4. FINDING THE RIGHT STIMULATION .....	14
5. MAXIMIZING THE DISTANCE .....	15
6. LED INDICATOR .....	16
7. CHARGING THE BATTERY.....	17
8. CHANGING THE STIMULATION DIAL .....	19
9. LCD ICONS .....	21
10. CHANGING THE BEACON & LOCATE LED	
LIGHT COLOR .....	21
11. CODE SETTING .....	22
12. CHANGING THE CONTACT POINT LENGTH .....	24
13. ATTACHING THE BELT CLIP .....	25
14. USING THE TEST LIGHT.....	26
15. REPLACING THE BATTERY .....	27

GENERAL TRAINING TIPS .....	31
MAINTENANCE .....	33
TROUBLESHOOTING GUIDE .....	34
WARRANTY AND REPAIR INFORMATION.....	36

# AT A GLANCE

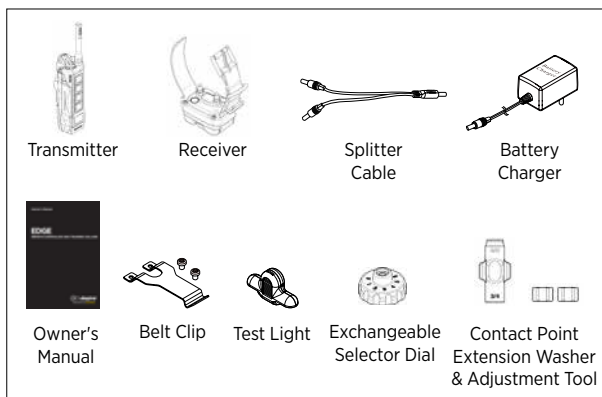

## Optional accessories

### Additional receivers

The Dogtra EDGE is expandable to a two, three, or four-dog system.

### Auto charger

Dogtra's auto chargers are designed for use with a 10-volt car outlet.

### European charger

Dogtra's european chargers are designed for use with a 230V AC electrical outlet.

To purchase accessories, please visit [www.dogtra.com](http://www.dogtra.com) or call customer service at (888) 811-9111.

# MAIN FEATURES

- Interchangeable stimulation dials
- Rheostat Dial with stimulation levels 0-127
- Selector Dial with stimulation levels 0-8
- 1-mile range
- 2 different stimulation types - Nick & Constant
- Pager vibration feature
- Beacon & Locate LED Light with 4 selectable colors (white, red, blue and green)
- User expandable to a two, three, or four-dog system
- Replaceable batteries
- Fully waterproof
- LCD screen
- Extendable contact points (5/8" to 3/4")
- Belt clip
- 2-hour rapid charge batteries

# OVERVIEW

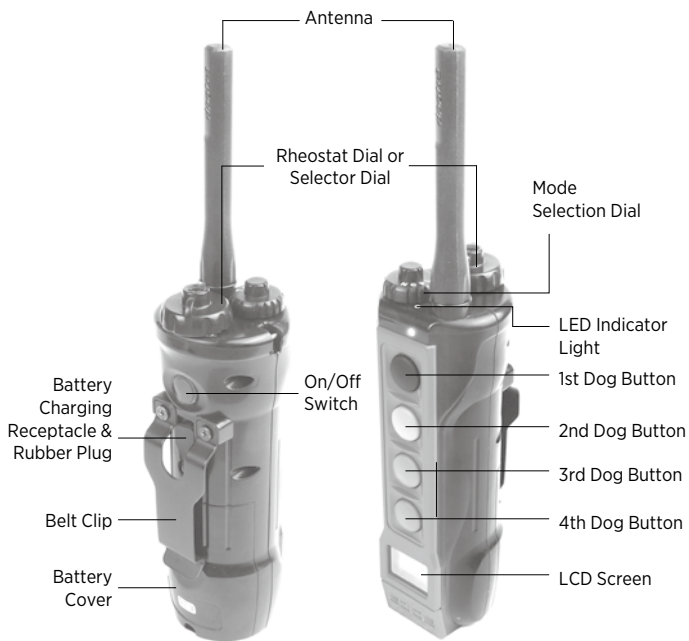

## EDGE Transmitter



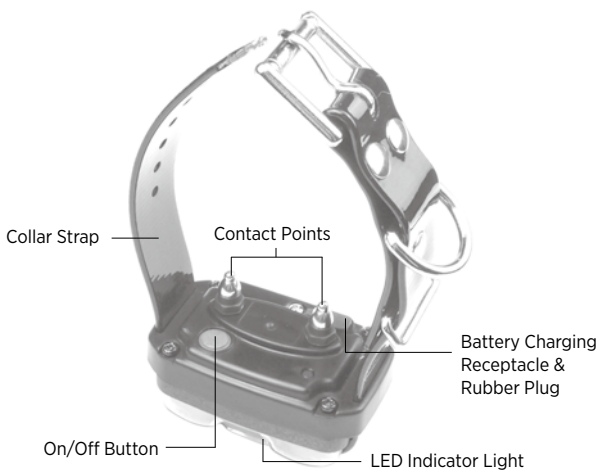

## **EDGE Receiver**



## **EDGE Receiver**

# UNDERSTANDING YOUR TRAINING SYSTEM

## 1. Turning the EDGE On/Off

To turn the transmitter on, hold down the blue button on the back of the transmitter until the LCD screen illuminates. To turn the transmitter off, hold down the blue button on the back of the transmitter until the LCD screen shuts off.



To turn the receiver on, hold down the on/off button until the LED indicator turns green. To turn the receiver off, hold down the on/off button until the LED indicator turns red.

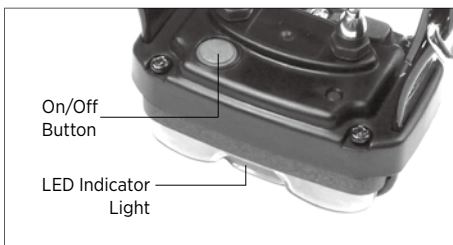

## 2. Transmitter Button Function

Turn the Mode Selection Dial to choose the desired function and press the button on the front for the receiver you would like to use.

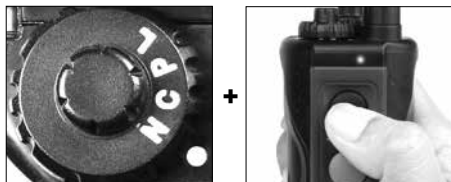

**N (Nick)** Nick is a single  $\frac{1}{2}$  second stimulation.

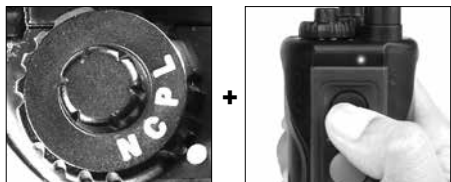

**C (Constant)** Constant gives a continuous stimulation as long as the button is pressed, for up to 12 seconds. If the button is not released after 12 seconds, the stimulation will automatically turn off as a safety feature.

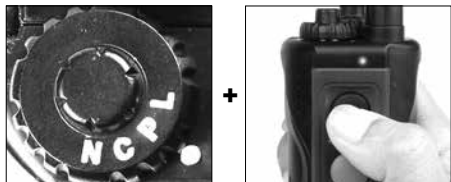

**P (Pager)** Pager gives a vibration for as long as the button is pressed, for up to 12 seconds.

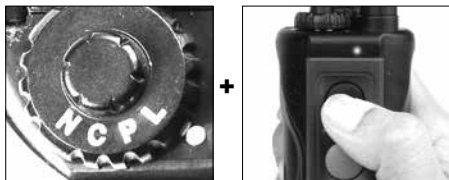

**L (Light)** High intensity Beacon & Locate LED Light on the receiver helps to find and distinguish dogs easily in low light/dark conditions.

To activate the light-locate mode, hold down the front transmitter button. The location light will continuously flash while the button is pressed, up to 12 seconds.

To activate the light-tracking mode, tap the front button on the transmitter once. The receiver LED location lights will now blink every 3 seconds. To deactivate the light-tracking mode, tap the front button on the transmitter once more.



The buttons on the front of the transmitter enables control of up to 4 receivers. Each of the 4 buttons on the transmitter can be coded to operate a different receiver. The receivers can be distinguished by coding the transmitter button to the matching receiver strap color.

### 3. Receiver Fitting

#### Proper Fit

The receiver should be fitted so that the surgical stainless steel contact points press firmly against the dog's skin. You should be able to fit two fingers underneath the collar strap. The best location is on either side of the dog's windpipe.

#### Improper Fit

A loose fit can allow the receiver to move around on the dog's neck. When this happens, the contact points may rub against the skin and cause irritation. If the receiver is too loose, the contact will not be consistent and cause the corrections to be inconsistent. Dogtra uses surgical stainless steel contact points and anti-microbial plastic to protect the dog's skin.

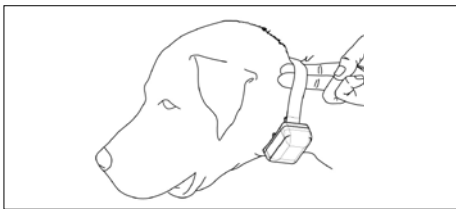

#### **Attention!**

Leaving the receiver in the same location on the dog's neck for an extended period of time can cause skin irritation. If the dog is to wear the receiver for long periods, occasionally reposition the receiver so that the contact points are moved to a different location on the dog's neck. Make sure you check for skin irritation each time you use the unit.

#### **4. Finding the Right Stimulation**

The EDGE has a Rheostat Dial on the top of the transmitter (0 is the lowest and 127 is the highest). It also comes with a Selector Dial that you can switch to have levels 1 (the lowest) to 8 (the highest). Remember that you will need to adjust the setting (upward or downward) depending on your dog's temperament and threshold for stimulation. Always start at the lowest level and work your way up. The appropriate level can be found when the dog responds to the stimulation with a mild reaction. Also, as the dog's attitude changes, especially during times of increased excitement or distraction, you may need to adjust the intensity level.

**NOTE:** The stimulation intensity can be adjusted even while the stimulation is in use.

## 5. Maximizing the Distance

The EDGE has a 1-mile range. Depending on the way you use your transmitter, the transmitter range may vary. To get the greatest range, hold the transmitter away from your body and avoid touching the antenna. Keep your unit properly charged for maximum signal strength.

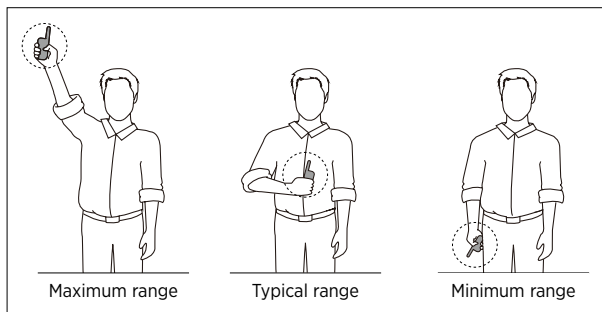

## 6. LED Indicator

The LED indicator flashes every 4 seconds when the receiver is on and ready for use. The LED indicator will blink on both the transmitter and the receiver when the transmitter buttons are pressed.

The LED indicator color indicates the battery life level.

**Green=Full charge**

**Amber=Medium charge**

**Red=Needs charge**

If the unit is used while the LED indicator is red, it may shut down automatically.



### Receiver Indicator Light

When the Constant button on the transmitter is pressed, the receiver indicator light will glow steadily (either green, amber, or red based on the remaining battery life), as long as you hold the button down, for up to 12 seconds. When the Nick button is pressed, the light comes on for a fraction of a second.



## 7. Charging the Battery

The Dogtra EDGE uses a lithium polymer battery. Recharge the unit if the indicator light is red or does not come on, the transmitter LCD shows only 1 bar on the indicator, or the system will not stay on when any button is pressed.

**NOTE 1:** Only use Dogtra-approved batteries, chargers, and accessories for your Dogtra e-collars. This will prevent any damage that can be incurred from attempting to use a different charger.

**NOTE 2:** The unit has a partial charge when it leaves the Dogtra facility. Upon receipt of the system, be sure to give it a full 2-hour initial charge before the first use away from any flammable substances.

**NOTE 3:** When a charger is not in use, disconnect it from the power source. Fully charge the batteries if the unit is to be stored without use for a period of 3 months or more.

### **Follow the steps below to charge your system:**

1. Open the rubber plugs on the battery charging receptacles and plug in the charging cable.
2. Plug the charger into a 120-volt wall outlet or, if using the auto charger, plug into a cigarette lighter only for lithium polymer batteries (use a 220 volt European charger for Europe). All indicator lights should glow red when properly plugged in and the unit will automatically shut off during the charging process. You will need to turn the unit on again before use once the unit is fully charged and unplugged from the battery cable.
3. The lithium polymer battery is fully charged within

- 2 hours. The lights will stay red during the charging process and turn green once the unit is fully charged.
4. After charging, cover the battery charging receptacles with the rubber plugs.

## 8. Changing the Stimulation Dial

The Dogtra EDGE has the ability to switch between the Rheostat Dial and the Selector Dial.

The EDGE unit comes installed with the Rheostat Dial To switch to the Selector Dial, follow the steps below.

1. Turn the stimulation level to 0.
2. Unscrew the top of the dial with a flathead screwdriver counterclockwise.
3. Remove the current dial knob and replace with the desired dial knob.
4. While firmly holding the dial knob in place, tighten the screw clockwise.

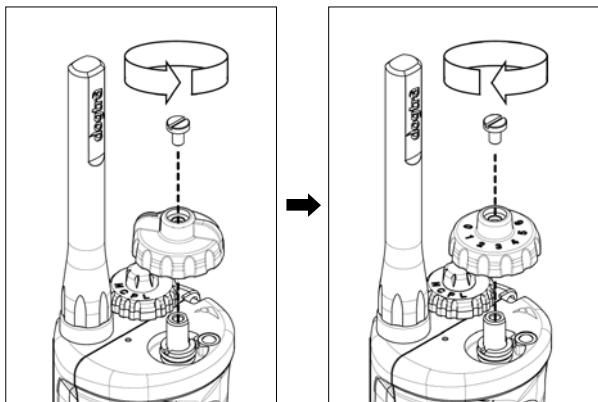

Next, change the program setting to the corresponding dial knob.

To change the program setting, follow the steps below.



1. Set the transmitter's intensity dial to 0.



2. Set the mode dial to "P".

Push  
simultaneously



3. Simultaneously hold down the black button on the front of the transmitter, along with the on/off blue button on the back of the transmitter.

4. The display on the LCD screen will now show the icon for the Rheostat Dial or the Selector Dial.  
Repeat the steps from the beginning, to switch back and forth from the Rheostat Dial or the Selector Dial.









Icon for the Rheostat Dial



Icon for the Selector Dial

## 9. LCD Icons

The icons on the LCD screen on the transmitter are listed below.

	Nick
	Constant
	Pager
	Light
	Rheostat Dial
	Selector Dial
	Battery life indicator

## 10. Changing the Beacon & Locate LED Light Color

The EDGE Beacon & Locate LED Light can be set to any of the 4 colors available.

To change the receiver location light to white, red, green, or blue, follow the instructions below,

1. Start with the receiver turned off.
2. Hold down the on/off button on the receiver for 10 seconds.

### **Attention!**

The on/off button must be pressed for a full 10 seconds.

3. Release the on/off button after the white location light flashes rapidly. The white location light will start flashing after the single green (small) LED indicator code setting light finishes blinking.

4. Press the on/off button once to set the desired color.
- \* The location light colors will rotate in the order of white, red, green, and blue for two full rotations.
  - \* The location light color will reset to the corresponding color when re-coded to another button.

## 11. Code Setting

Follow the steps below to code an EDGE transmitter to a new or existing receiver.



1. Turn on the transmitter by holding down the on/off button on the back of the transmitter.



2. Set the transmitter's stimulation dial to "0" and the mode selection dial to "C".



3. With the receiver turned off, hold down the on/off button on the receiver until the LED light begins to rapidly blink green.



4. While the green LED is rapidly blinking on the receiver, press the button on the transmitter of the color you would like to code the receiver to. The LED light on the receiver will blink every 4 seconds when coding is complete.

**Attention!**

Turn the mode selection dial to "P", or "L", to check that unit has been coded properly.

## 12. Changing the Contact Point Length

The Dogtra EDGE comes equipped with standard 5/8" contact points that can be extended to 3/4" contact points to use on dogs with longer coats. To increase the contact point length from 5/8" to 3/4", follow the steps below.

1. Using the included adjustment tool with the side marked 5/8", unscrew the contact points counter-clockwise.
2. Place the contact point extension over the exposed threads, flat side down.
3. Place the contact points over the extensions and tighten the contact points and extensions clockwise using the adjustment tool with the side marked 3/4".

### Caution

Tighten until firmly in place. Be careful not to over tighten.

To shorten the contact points back to the standard 5/8", start with the adjustment tool with the side marked 3/4", remove the contact point extensions, and tighten the contact points with the adjustment tool with the side marked 5/8".

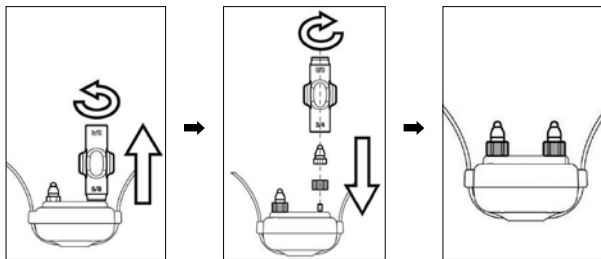



### 13. Attaching the Belt Clip

Follow the instructions below to attach the included belt clip to the transmitter.

1. Align the belt clip to the grooves on the back of the transmitter.
2. With a firm grip, screw on the belt clip's Phillips head screws with a screwdriver.

#### **Caution**

Tighten until firmly in place. Be careful not to over tighten.

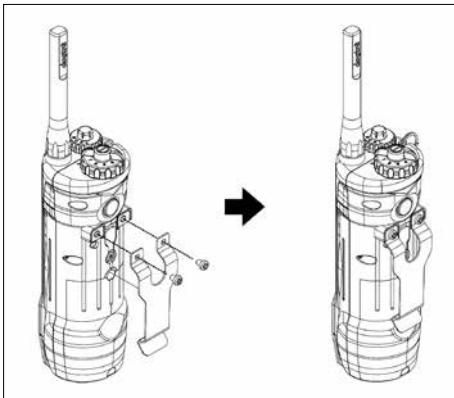

## 14. Using the Test Light

1. Turn on the receiver by pressing the on/off button. The indicator light will come on for a moment then blink once every 4 seconds, showing that the receiver is ready to use (the receiver needs to be charged if the indicator light is red).
2. Turn the transmitter on by holding down the on/off button on the transmitter. The LED will blink every 4 seconds and the LCD screen will show the remaining battery life.
3. Place the test light, included in the package contents, on the contact points as shown in the diagram.
4. Watch the test light as you push the Nick button on the transmitter. It should light up for just a moment. The higher the intensity, the brighter the test light will be. Watch the test light as you push the Constant button on the transmitter. It should light up as long as the button is pressed. However, as a safety feature, the receiver will automatically stop the stimulation if the Constant button is pressed for 12 seconds or longer.
5. Turn the Rheostat Dial on the transmitter clockwise and then counterclockwise. The test light should glow brighter with higher levels of stimulation and dimmer with lower levels.

**Note:** The test light may not be visible if the intensity level is set below level ten.

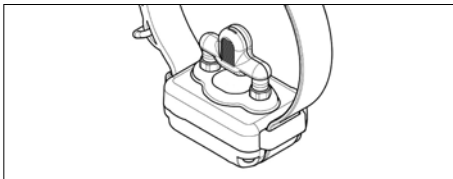

## 15. Replacing the Battery

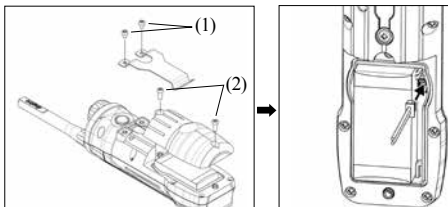

The EDGE batteries are user replaceable. To replace the battery in the transmitter, follow the instructions below.

1. Begin with the transmitter turned off.
2. Unscrew the two Phillips head screws attached to the back of the belt clip and remove the belt clip.
  - \* Unscrew the screws with a firm grip, taking extra caution to not strip the screws.
3. Unscrew the two screws on the back of the transmitter.
  - \* Unscrew the screws with a firm grip, taking extra caution to not strip the screws.
4. Holding the battery wire, detach the wire from the battery connector plug (see image on next page).
5. Holding the battery wire of the new battery, plug the wire in to the battery connector plug.

**Attention!** The battery wire plugs indented to fit in one way to the connector.

6. Check that the battery connector wire is firmly inserted into the plug. The battery wires must be inside the battery compartment tucked neatly along the right side of the battery.



**Caution**

Do not detach the wire by pulling from the battery.

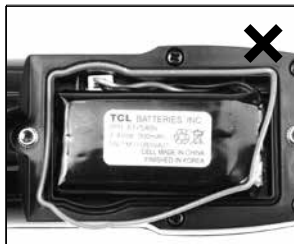
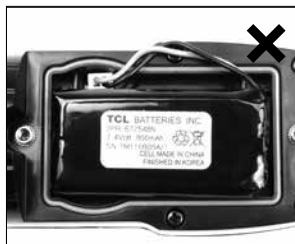

**Caution**

The battery wires must be inside the battery compartment tucked neatly along the right side of the battery.

**Caution**

The orange rubber gasket is important for the unit to be waterproof and must be properly seated in place.

7. Fasten the battery cover and the belt clip back on the transmitter with the four screws.

**To replace the battery in the receiver, follow the instructions below.**

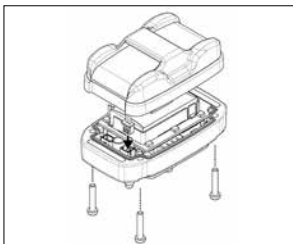
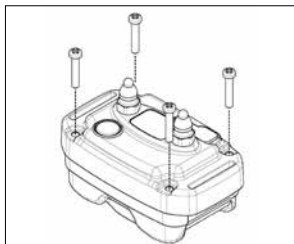

1. Begin with the receiver turned off.
  2. Remove the strap and unscrew the Phillips head screws on the four corners of the receiver.
- \* Unscrew the screws with a firm grip, taking extra caution to not strip the screws.
3. Remove the front case. While holding the battery wire, detach the wire from the battery connector plug.
  4. Holding the battery wire of the new battery, plug the wire in to the battery connector plug.
  5. Check that the battery connector wire is firmly inserted into the plug. The battery wires must be inside the battery compartment.



### Caution

Do not detach the wire by pulling from the battery.



### Caution

The battery wires must run neatly along the top left side in to the battery compartment.



### Caution

The orange rubber gasket is important for the unit to be waterproof and must be properly seated in place.

## **GENERAL TRAINING TIPS**

Your dog must know some basic obedience commands before beginning training with the EDGE. A dog learns by first being shown a command, followed by lots of repetition over an extended period. As the dog becomes proficient at these commands, the trainer can introduce distractions and different locations to strengthen them.

### **Obedience Training on the Leash**

Your dog must fully understand the obedience commands (sit, stay, here, heel, and kennel) before using the e-collar for reinforcement of these commands. A leash attached to a standard collar is used to "teach" the dog the basic obedience commands (here, heel, sit, and stay). A tug on the leash/collar is used to reinforce the command. When the dog complies with the command, use positive reinforcement/praise. Once the dog understands these commands, the e-collar can be used to reinforce them.

### **Beginning E-Collar Training**

When you feel your dog understands the obedience commands on the leash we can now start with the e-collar training. With the dog on the leash and wearing the e-collar, continue with your obedience drills. Apply light stimulation (Nick or Constant) when a command is given; the stimulation can be removed as the dog complies. Through repetition, the dog learns to perform the command. The final step is the avoidance phase in which the dog learns that he can avoid the stimulation altogether by performing your commands. When these training procedures are complete, the e-collar is used as a reminder when the dog does not comply with your

commands at home or in the field. Keep your initial training sessions short and positive as dogs have a short attention span.

### **How Much Stimulation to Use**

Always start with low levels of stimulation and worm your way up depending on the disposition of your dog and the given situation. By using the correct amount of stimulation to get your point across, you will have a more controllable environment and a dog that is under less stress. Animals (and humans) perform better in a less stressful environment.

**For more training information, please visit our website at [www.dogtra.com](http://www.dogtra.com).**



# MAINTENANCE

## **Basic maintenance**

Be sure the rubber-charging cap is securely in place when the e-collar is in use. After each training session, carefully inspect the unit for any missing parts or damage to the casing. Damaged or broken casing may affect the waterproof guarantee on the unit. After confirming that there is no damage to the casing, rinse the receiver and clean out any dirt or debris.

## **Storage maintenance**

The EDGE should be fully charged before storing for extended periods. While in storage, the unit should be given a full charge once a month and before the first use. Store the units in room temperature. Do not keep the units exposed to extreme climates.

## **Troubleshooting**

If the unit is malfunctioning, please refer to the “Troubleshooting Guide” before sending it to Dogtra for service. If you have any questions or concerns, you may email them to [info@dogtra.com](mailto:info@dogtra.com), or call customer service at (888) 811-9111.

# TROUBLESHOOTING GUIDE

## **1. My dog is not reacting to the receiver.**

- Make sure the receiver and transmitter are both turned on until the LED lights up.
- Make sure the collar strap is tight enough so both contact points are touching the dog's skin.
- The contact points may be too short for the dog. To place an order for longer contact points that are more appropriate for your dog, please call (888) 811- 9111. If you are already using the longest contact points available, you might need to trim down the hair on the dog's neck so both contact points are touching the dog's skin.
- The intensity level may be too low for your dog. Keep increasing the stimulation until the dog responds, usually with neck movement, head shaking, looking over its shoulder, etc. (response may be very subtle).

## **2. The test light comes on, but I do not feel any stimulation.**

- Your tolerance may be higher than your dogs. We recommend placing both contact points on your inner wrist where the sensitivity is higher in order to test the unit.
- The battery may be low, so check the LED light for battery life.

### **3. The transmitter has no range or stimulation is less when the dog is farther away.**

- The antenna(s) may be damaged. To order parts, please contact customer service at (888) 811- 9111 or go to [www.dogtra.com](http://www.dogtra.com).
- The range indicated on the unit's box is for flat terrain. Heavy brush, trees, hills, or moisture will affect the range of your unit. For best range, hold the transmitter vertically above your head, and/or try moving to higher ground.
- Any electrical conductors will affect the range, such as cars, chain-link dog runs, metal structures, and radio towers. For best results, operate away from these items.

### **4. My unit is not holding a charge.**

- The batteries might not be charged properly, or the charger, splitter, and the charging port may not be functioning properly. You can send in your charging units to have us inspect them.
- The charging pin may be damaged. Inside the charging port, there is a metal pin that should be standing straight up and stiff. If the pin is wobbling, broken, or missing, you will need to send the unit in to the Repair Department. The charging port must be clean prior to charging; clean the dirt out with a cotton swab and some rubbing alcohol. If the dog is in salt-water, be sure to rinse the receiver and charging port with clean water.
- If the above does not resolve your issues, contact Dogtra customer service at [info@dogtra.com](mailto:info@dogtra.com) or (888) 811-9111.

# DOGTRA EXTENDED PRODUCT WARRANTY

## EXTENDED LIMITED WARRANTY

### For Certain Dogtra Products Purchased from Dogtra Authorized Dealers

#### 1+1 Year Extended Warranty

Except as otherwise provided, Dogtra warrants to the original retail purchaser (“You”) that your Dogtra product shall be free of defects in materials and workmanship for a period of one (1) year from the date of purchase (“Original Warranty”). As a special promotion, Dogtra further warrants that your Dogtra product shall be free of defects in materials and workmanship for an additional one (1) year from the date that your original warranty expires (“Extended Warranty”). The Original and Extended Warranties cover the cost of repair (parts and labor) or replacement (if repair is not feasible) of a defective Dogtra product during said warranty periods. For such repaired or replaced products, the remaining portion of the warranty periods, or ninety (90) days, whichever is longer, shall apply. Dogtra, at its sole discretion, shall determine whether to repair or replace a product covered by the Original Warranty or Extended Warranty.

#### Warranty Conditions

The Original and Extended Warranties are not transferrable and apply to your Dogtra product only if:

- (1) You are the original retail purchaser of the product,
- (2) You bought the product from a Dogtra Authorized Dealer, and
- (3) You present a receipt or other proof of purchase showing a valid purchase date, the name and address of the Dogtra Authorized Dealer, and the purchased product identified by model and/or serial number.

#### Warranty Exclusions

The Original and Extended Warranties do not cover damage, loss, or deterioration to your Dogtra product caused: by misuse, neglect, abuse, or other improper handling of the product; by failure to follow use or care instructions; by use of the product for other than its intended purpose; by accident or natural forces such as fire or flooding; or by normal wear and tear such as scratches to the product surface.

The Original and Extended Warranties also do not cover Dogtra products that: are purchased from non-authorized dealers; are purchased outside of the United States or Canada; have been damaged during shipment (even if Dogtra paid or arranged for shipping); have been modified or tampered with in any manner; are opened or repaired by anyone other than Dogtra; or have serial numbers that have been altered or defaced.

### **Sole Warranties**

The Original and Extended Warranties are the only warranties offered by Dogtra for your Dogtra product during said warranty periods. Other than the Original and Extended Warranties, Dogtra makes no other representations or warranties whatsoever regarding its products, whether oral or in any product manual, on any packaging, on any website, or in any other written material. No dealer of Dogtra products, nor any employee or agent of Dogtra, is authorized to make any additions, changes, or extensions to the Original Warranty or Extended Warranty. Dogtra, at its sole discretion and at any time, reserves the right to modify the Original and/or Extended Warranties.

### **DISCLAIMER OF OTHER WARRANTIES**

**THE FOREGOING ORIGINAL AND EXTENDED WARRANTIES ARE PROVIDED IN LIEU OF ALL OTHER WARRANTIES, WHETHER EXPRESS OR IMPLIED. DOGTRA DISCLAIMS ANY IMPLIED WARRANTIES INCLUDING, BUT NOT LIMITED TO, THE IMPLIED WARRANTIES OF MERCHANTABILITY AND FITNESS FOR A PARTICULAR PURPOSE.**

### **Limitation of Remedies**

Dogtra's liability is limited to the cost of repair or replacement of the Dogtra product under the Original Warranty or Extended Warranty. Any claim or action to enforce the Original and/or Extended Warranties must be commenced within thirty (30) days of such warranty's expiration for your product. Dogtra will not be liable for any indirect, incidental, special, consequential, or similar damages based on breach of warranty, breach of contract, negligence, strict tort, or any other legal theory related to Dogtra and its products. Damages that Dogtra will not be responsible for include, but are not limited to: loss of income or profits; loss of revenue or savings; loss of use of the product or associated products; cost of any substitute products or services; inconvenience, downtime, or any other time; loss of goodwill; claims of third parties including customers; and damage to property.

### **Legal Rights May Vary By State or Jurisdiction**

The Original and Extended Warranties give You specific legal rights, and You may also have other rights which vary by state or jurisdiction. Some states or jurisdictions do not allow certain limitations of implied warranties or of incidental or consequential damages or other remedies, so certain of the foregoing limitations may not apply to You.

If any portion of the Original Warranty or Extended Warranty is held by a court to be invalid or unenforceable, the remaining portions of such warranties shall remain in full force and effect and shall in no way be affected or invalidated, and the invalid or unenforceable portion shall be modified so as to most nearly achieve the intent of the Original Warranty or Extended Warranty.

### **Product Registration**

Dogtra recommends that customers register their products as soon as possible after purchase. Product registration will facilitate any future warranty service. You may also receive useful information and updates about your existing and future Dogtra products. To register your product, visit [www.dogtra.com/product-registration](http://www.dogtra.com/product-registration). If your product is not registered with Dogtra, You will be required to provide a receipt or other proof purchase (as provided above) to qualify for warranty service.

### **How to Obtain Warranty Service**

Should your Dogtra product require warranty service, please contact Customer Service by phone or email for a warranty evaluation (see below for contact information). Upon approval of your warranty work, Dogtra will repair or replace (at Dogtra's election) your product without charge for labor or parts. You are responsible for shipping, including cost, of your product to Dogtra for warranty service. Dogtra will handle shipping, including cost, of the repaired or replaced product back to customers in the USA. Dogtra will not be responsible for shipping, including cost and/or applicable taxes or fees, for products sent outside the USA. Such costs, taxes, or fees will be borne by the customer.

### **Dogtra Customer Service**

**22912 Lockness Avenue, Torrance, CA 90501**

(888) 811-9111

repair@dogtra.com

Mon – Fri, 8:00 AM to 4:30 PM (PST)

© 2020 Dogtra. All rights reserved.